

ICOM INSTRUCTIONS

PTT MICROPHONE ADAPTER

CT-23

PRECAUTIONS

⚠ **WARNING! NEVER** connect a power adapter to the CT-23 other than the specified one. This may cause a fire or damage the CT-23.

CAUTION: NEVER connect a microphone to the CT-23 other than the specified one. Other microphones may have different pin assignments, and could damage the CT-23 or the microphone.

CAUTION: NEVER expose the CT-23 to rain, snow or any liquids. This may damage the CT-23.

CAUTION: NEVER let metal, wire or other objects protrude into the connector.

DO NOT use or place the CT-23 in areas with temperatures below 0°C (32°F) or above 40°C (104°F).

DO NOT use harsh solvents such as Benzine or alcohol to clean the CT-23. They will damage the CT-23's surfaces.

TIP:

Output audio from the CT-23 includes high pitch tones that humans can hardly hear. However, when you playback any recorded audio while using the CT-23, it might be better to not turn the volume too high.

Thank you for choosing this Icom product.
READ ALL INSTRUCTIONS carefully and completely before using this product.

DISPOSAL



The crossed-out wheeled-bin symbol on your product, literature, or packaging reminds you that in the European Union, all electrical and electronic products, batteries, and accumulators (rechargeable batteries) must be taken to

designated collection locations at the end of their working life. Do not dispose of these products as unsorted municipal waste. Dispose of them according to the laws in your area.

Icom is not responsible for the destruction, damage to, or performance of any Icom or non-Icom equipment, if the malfunction is because of:

- Force majeure, including, but not limited to, fires, earthquakes, storms, floods, lightning, other natural disasters, disturbances, riots, war, or radioactive contamination.
- The use of Icom transceivers with any equipment that is not manufactured or approved by Icom.

FEATURES

○ **Make Land Mobile microphones usable for NXDN or dPMR system**

When the SM-26/SM-25 (discontinued product) STAND MICROPHONE or the HM-152 HAND MICROPHONE is connected to a Remote Communicator (PC) through the CT-23, you can make full use of the microphone for your NXDN or dPMR system.

○ **POWER/TRANSMIT indicator**

The CT-23 has a POWER/TRANSMIT indicator on the top panel that indicates the operating status.

○ **External switch is connectable**

When an external switch is connected, you can use it instead of the microphone's [PTT] switch or [MONITOR] switch.

○ **Easy connections**

The CT-23 has 4 different types of connectors for safe, easy connection.

SUPPLIED ITEMS

| Item | Qty. |
|-----------------------------|------|
| ① CT-23 | 1 |
| ② Self tapping screws | 2 |
| ③ Audio cable | 1 |

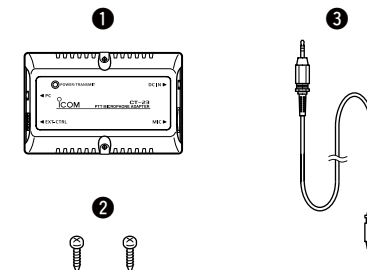

FCC INFORMATION

For CLASS B UNINTENTIONAL RADIATORS

This equipment has been tested and found to comply with the limits for a Class B digital device, pursuant to part 15 of the FCC Rules. These limits are designed to provide reasonable protection against harmful interference in a residential installation. This equipment generates, uses and can radiate radio frequency energy and, if not installed and used in accordance with the instructions, may cause harmful interference to radio communications. However, there is no guarantee that interference will not occur in a particular installation. If this equipment does cause harmful interference to radio or television reception, which can be determined by turning the equipment off and on, the user is encouraged to try to correct the interference by one or more of the following measures:

- Reorient or relocate the receiving antenna.
- Increase the separation between the equipment and receiver.
- Connect the equipment into an outlet on a circuit different from that to which the receiver is connected.
- Consult the dealer or an experienced radio/TV technician for help.

CONNECTIONS

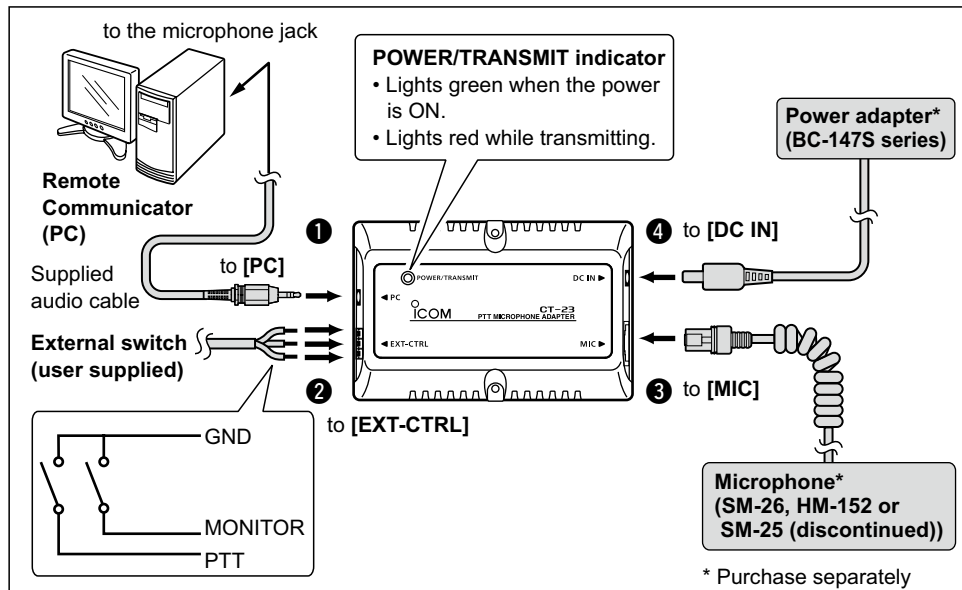

Connect the components to the CT-23 in the following order:

① PC connection

Connect the microphone jack of the Remote Communicator (PC) and [PC] using the supplied audio cable.

- ① The sound card of the PC must cover the frequency response range of up to 20 kHz, and have a sampling rate of 48 kHz, for the PTT and Monitor* function.

② External switch connection

Connect an external switch (user supplied) to the [EXT-CTRL] connector to remotely control the PTT and Monitor* function.

③ Microphone connection

Connect the SM-26, HM-152 or SM-25 (discontinued product) to [MIC]. You can use the following functions for your NXDN or dPMR system.

- PTT function
- Monitor function

- ① Push the SM-26's or SM-25's [MONITOR] switch, or take the HM-152 off the hook to use the Monitor function.

④ Power adapter connection

Connect one of the power adapters in the BC-147S series that matches your power voltage requirements.

- The POWER/TRANSMIT indicator lights green.

NOTE: Be sure to connect the power adapter last.

TIP:

When the microphone is connected, you can transmit the microphone audio not only with the microphone's [PTT] switch, but also with the Remote Communicator's [PTT] button, or the external switch. To use the CT-23's PTT/Monitor function, set the function to ON in the remote communicator (IP100FS/RC-FS10).

See the remote communicator manual for details.

DIMENSIONS AND INSTALLATION

- Dimensions (approximate)

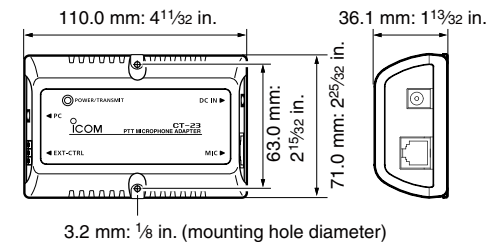

Mount the CT-23 onto a solid flat surface using the 2 supplied screws through the mounting holes.

INFORMATION

The following problems may occur, depending on the PC's sound card.

- If the [PTT] switch on the microphone, or the external switch does not work, disable the Filtering function of the sound card.
- If the CT-23 produces a disturbing noise, disable the Mic boost of the sound card.

- ① For setting details, refer to the manual that comes with the sound card or PC.

EXT-CTRL CONNECTOR

The PTT or Monitor function is activated when the PTT or Monitor control line is connected to the ground.

① Information

- The monitor function is activated when the MONITOR switch is closed.
- To control the monitor function from the external switch, connect the specified microphone to the CT-23.

Specifications

| | |
|--------------------------|------------------------------|
| Open terminal voltage | 3.3 V DC |
| Terminal current when ON | 1 mA (maximum) |
| Connector type | One-touch terminal (3 poles) |

- ① Use wires with diameter of 0.4 to 1.2 mm: 1/64 to 3/64 inches.

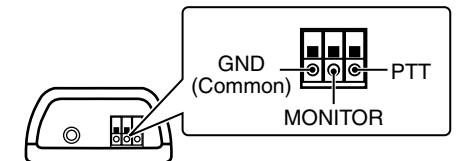

SPECIFICATIONS

- Power Supply voltage: 12 V DC (supplied from the power adapter)
- Operating temp range: 0°C to 40°C (32°F to 104°F)
- Relative humidity: 5% to 95%
- Weight (approximate): 93 g (3.28 oz)
- Length of the audio cable (approximate): 1 m (3.28 ft)

All stated specifications are subject to change without notice or obligation.

Icom, Icom Inc. and Icom logo are registered trademarks of Icom Incorporated (Japan) in Japan, the United States, the United Kingdom, Germany, France, Spain, Russia, Australia, New Zealand, and/or other countries.

NXDN is a trademark of Icom Incorporated and JVC KENWOOD Corporation.

dPMR and the dPMR logo are trademarks of the dPMR MoU Association.

Icom Inc.

1-1-32 Kamiminami, Hirano-ku, Osaka 547-0003, Japan.

Count on us!

A-6775D-1EX-① Printed in Japan
© 2009–2017 Icom Inc.